

DN 65-100 ▲

DN 15-25 ▲

BBS/FZL

BALL VALVE WITH FLANGES, LONG PATTERN

DN 15-100 | PN 10-63

FULL BORE

MATERIALS

MATERIALS	PN	DN	Standard
Body	10-40	15-25	Steel
	63	65-100	Steel
Ball	10-40	15-25	Steel, hard chromed
	63	65-100	Ductile iron, hard chromed
Sealings	10-40	15-25	PTFE
	63	65-100	PTFE

INFORMATION

Ball Valve with flanges

/// Length face-to-face DIN EN 558 FTF 1

/// Flange dimensions DIN EN 1092-1,
Form B1 (bis PN40)
Form B2 (PN63+PN100/160)

/// DN 15-25: one-piece body

/// DN 65-100: two-piece body

/// The lever is included

OPTIONS

/// Also available in Fire-Safe version with
Test certificate according to BS 6755 and/or
with TÜV component mark.

/// Other shapes of flange sealing surfaces
on request

/// Special designs on request

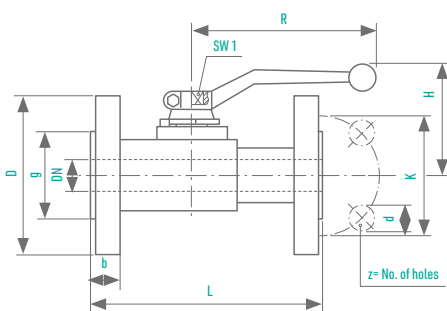

	DN	PN	L	D	g	K	b	z	d	H	R	SW1	Wght	Order Number
PN 10-25 Raised face	15	25	130	95	45	65	16	4	14	93	130	10	2,5	0626676
	20	25	150	105	58	75	18	4	14	90	180	10	3,3	0626677
	25	25	160	115	68	85	18	4	14	93	180	12	4,2	0626678
PN 40 Raised face	15	40	130	95	45	65	16	4	14	93	130	10	2,5	0626679
	20	40	150	105	58	75	18	4	14	90	180	10	3,3	0626680
	25	40	160	115	68	85	18	4	14	93	180	12	4,2	0626681
PN 63 Raised face	65	63	290	205	122	160	26	8	22	146	300	16	22,5	0620162
	80	63	310	215	138	170	28	8	22	160	500	22	35,0	0620001
	100	63	350	250	162	200	30	8	26	175	500	22	41,0	0624394