

e-chains® | Series 1400 | Crossbars openable along the inner radius, from both sides
 e-chains® | Series 1500 | Crossbars openable along the outer radius, from both sides

Part No. e-chains® openable along inner radius	Part No. e-chains® openable along outer radius	Bi [mm]	Ba [mm]	R Available bend radii [mm]	1400 [kg/m]	1500 [kg/m]
1400.015 .R.0	1500.015 .R.0 [▲]	15	28.5	035 038 048 075 100 125 145 180	≈ 0.46	≈ 0.46
1400.020 .R.0 [⊙]	1500.020 .R.0	20	33.5	035 038 048 075 100 125 145 180	≈ 0.47	≈ 0.47
1400.025 .R.0 [⊙]	1500.025 .R.0 [▲]	25	38.5	035 038 048 075 100 125 145 180	≈ 0.49	≈ 0.49
1400.038 .R.0 [⊙]	1500.038 .R.0 [⊙]	38	51.5	035 038 048 075 100 125 145 180	≈ 0.53	≈ 0.53
1400.050 .R.0 [⊙]	1500.050 .R.0 [▲]	50	63.5	035 038 048 075 100 125 145 180	≈ 0.56	≈ 0.56
1400.068 .R.0 [⊙]	1500.068 .R.0 [▲]	68	81.5	035 038 048 075 100 125 145 180	≈ 0.63	≈ 0.63
1400.080 .R.0 [⊙]	1500.080 .R.0 [▲]	80	93.5	035 038 048 075 100 125 145 180	≈ 0.67	≈ 0.67
1400.100 .R.0 [⊙]	1500.100 .R.0	100	113.5	035 038 048 075 100 125 145 180	≈ 0.74	≈ 0.74
1400.125 .R.0	1500.125 .R.0	125	138.5	035 038 048 075 100 125 145 180	≈ 0.83	≈ 0.83

▲ ESD version (Electro Static Discharge) available from stock. More information ► From page 142
 ⊙ RBR version (Reverse Bend Radius), some radii available from stock. More information ► From page 130
 Half e-tubes, series 1450 and full e-tubes, series 1480 ► From page 388
 Complete Part No. with required radius (R). Example: 1500.038.100.0

ESD - many sizes from stock

- Standardised product made from igumid ESD
 - ESD material tested for over 10 million cycles for the toughest requirements
 - Short delivery times including mounting brackets and interior separation; 24hrs, from stock
- More information and the complete product range
 ► From page 142 or at ► www.igus.eu/esd

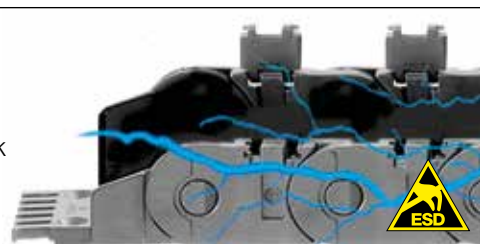

Rotating energy supply systems with Reverse Bend Radius (RBR) - some radii available from stock

- Maximum rotation angle in minimal installation space
 - Minimal friction forces and maximum service life
 - Short delivery times, from stock
- More information and the complete product range ► From page 130

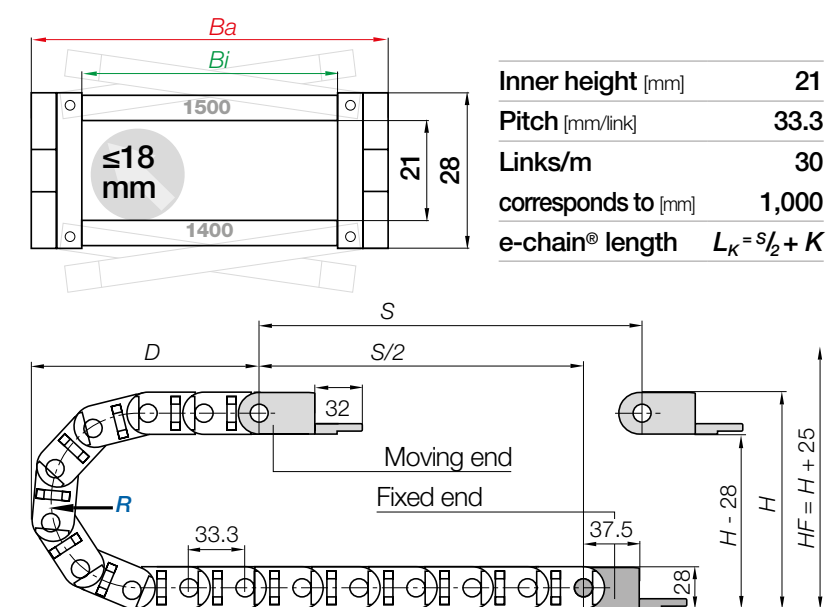
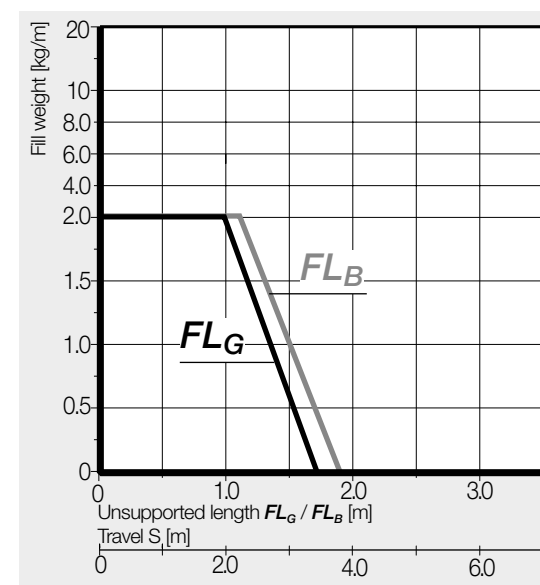

Inner height [mm]	21
Pitch [mm/link]	33.3
Links/m	30
corresponds to [mm]	1,000
e-chain® length	$L_K = \frac{S}{2} + K$

R	035	038	048	075	100	125	145	180
H	98	104	124	178	228	278	318	388
D	99	102	112	139	164	189	209	244
K	180	190	220	305	385	460	525	635

The required clearance height: $H_F = H + 25\text{mm}$ (with 0.5kg/m fill weight)

Before using series 1400 on long travels please consult igus®.

Gliding applications | For travel lengths 10m to max. 75m

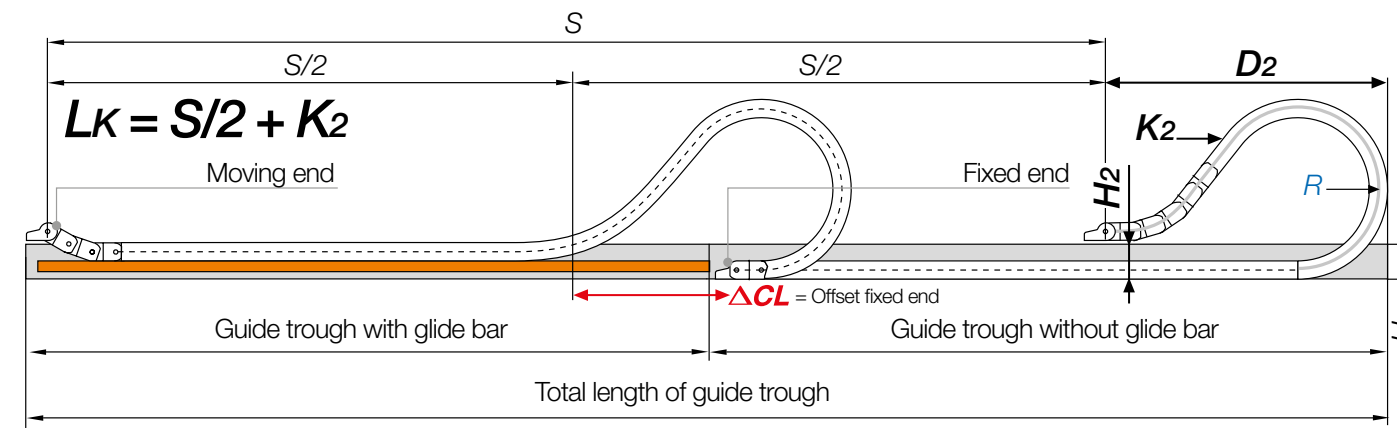

Note: before using series 1400/1450/1480 on long travels please consult igus®.

For long travels, igus® recommends series 1500 openable along the outer radius.

In case of travels between 4 and 10m we recommend an e-chain® with a longer unsupported length.

R	035	038	048	075	100	125	145	180
H ₂	70	76	96	150	100	100	100	100
D ₂ ⁺²⁵	99	102	112	139	340	495	540	690
K ₂	180	190	220	305	600	800	940	1,170
ΔCL	-	-	-	-	179	305	340	445

Before using series 1400 on long travels please consult igus®.

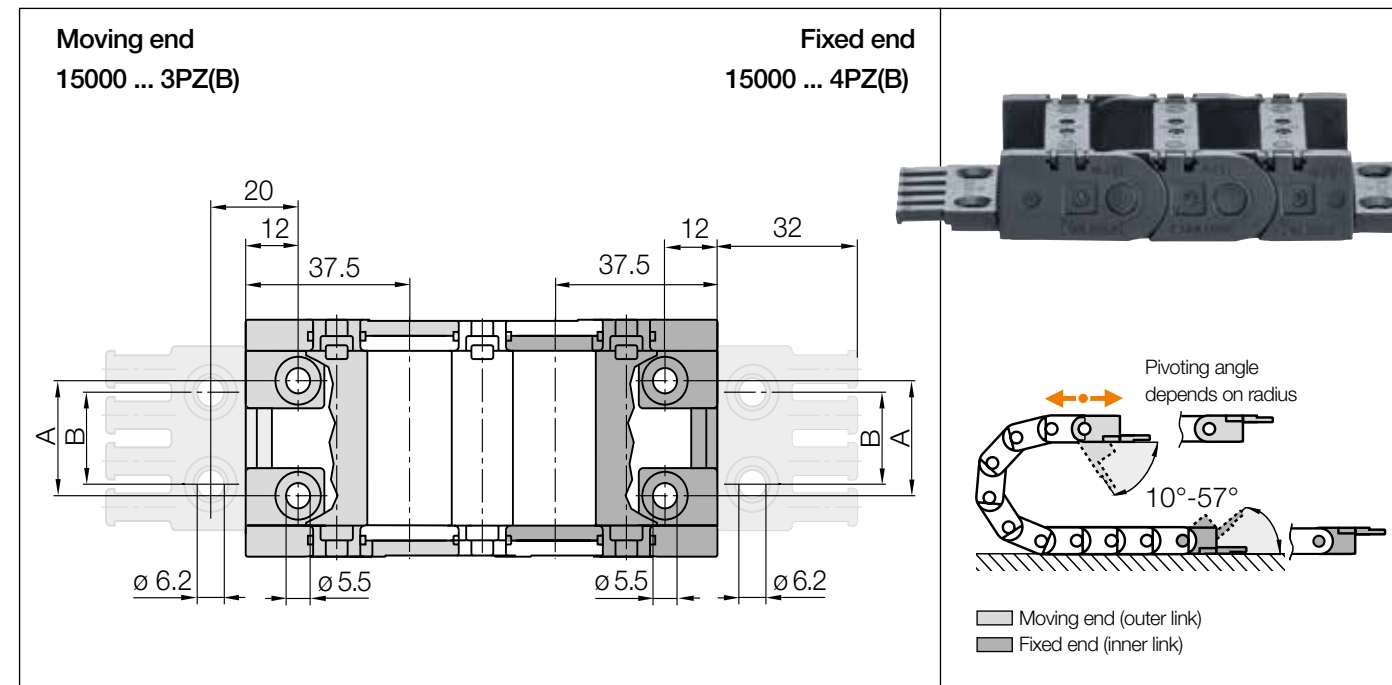
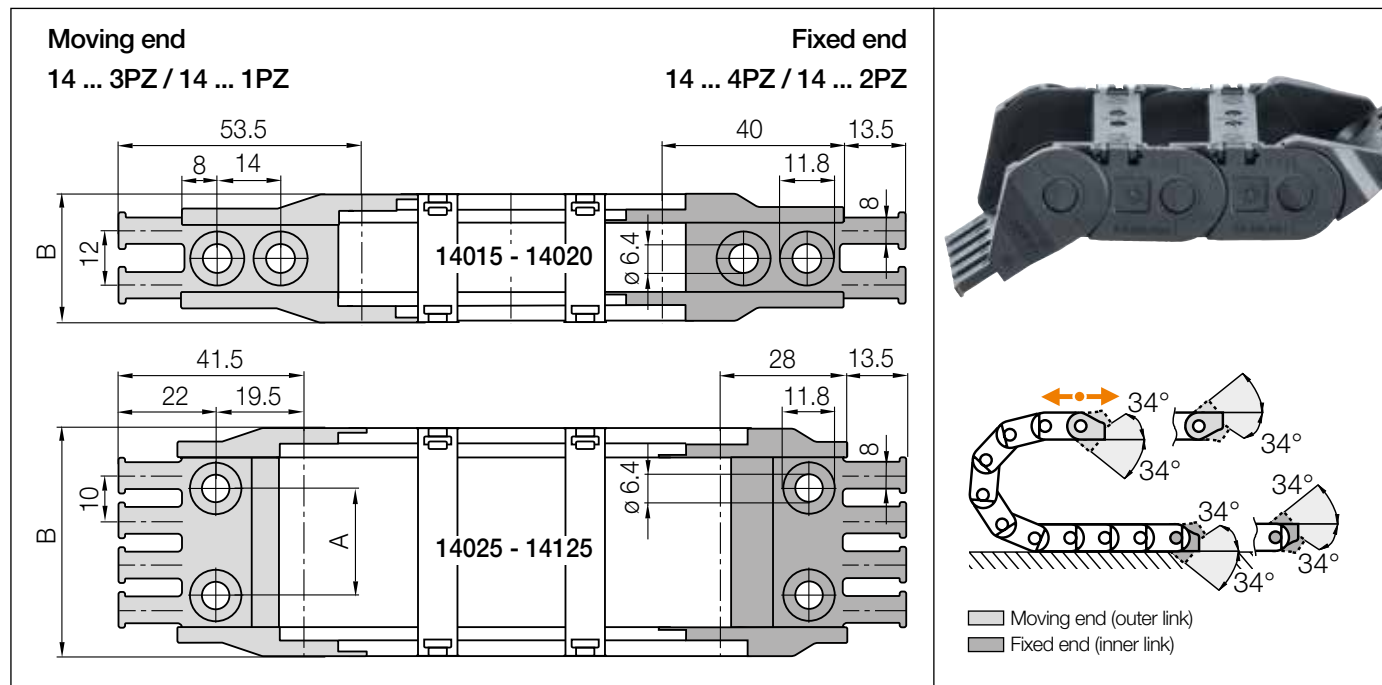

Polymer pivoting | Recommended for unsupported and gliding applications
Polymer locking | Recommended for vertical hanging and standing applications

Width index	Part No. full set pivoting		Part No. full set locking		A [mm]	B [mm]	Number of teeth
	with tiewrap plates	without tiewrap plate	with tiewrap plates	without tiewrap plate			
015. ▶	14015.34PZ	-	14015.12PZ	-	-	28.5	2
020. ▶	14020.34PZ	-	14020.12PZ	-	-	33.5	2
025. ▶	14025.34PZ	-	14025.12PZ	-	13	38.5	2
038. ▶	14038.34PZ	-	14038.12PZ	-	24	51.5	4
050. ▶	14050.34PZ	-	14050.12PZ	-	36	63.5	5
068. ▶	14068.34PZ	-	14068.12PZ	-	54	81.5	7
080. ▶	14080.34PZ	-	14080.12PZ	-	66	93.5	8
100. ▶	14100.34PZ	-	14100.12PZ	-	86	113.5	10
125. ▶	14125.34PZ	-	14125.12PZ	-	111	138.5	13

Polymer pivoting | Recommended for unsupported and gliding applications
For tight installation spaces

Width index	Part No. full set pivoting		Part No. full set locking		A [mm]	B [mm]	Number of teeth
	with tiewrap plates	without tiewrap plate	with tiewrap plates	without tiewrap plate			
015. ▶	-	-	-	-	-	-	-
020. ▶	-	-	-	-	-	-	-
025. ▶	15000.025.34PZB	15000.025.34PZ	-	-	12	15	3
038. ▶	15000.038.34PZB	15000.038.34PZ	-	-	25	20	4
050. ▶	15000.050.34PZB	15000.050.34PZ	-	-	37	30	5
068. ▶	15000.068.34PZB	15000.068.34PZ	-	-	55	40	6
080. ▶	15000.080.34PZB	15000.080.34PZ	-	-	67	60	8
100. ▶	15000.100.34PZB	15000.100.34PZ	-	-	87	80	10
125. ▶	15000.125.34PZB*	15000.125.34PZ*	-	-	112	100	12

*Tiewrap plate (consists of 2x2050.ZB) does not snap on but needs to be bolted down separately.

Note: mounting brackets not to assemble at the gable end.

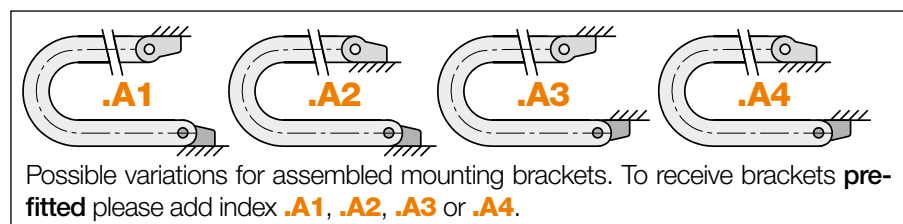

14038.34PZ.A1 Order example
 .A... to indicate option with brackets pre-fitted
 With integrated strain relief tiewrap plates
 Full set
 Series

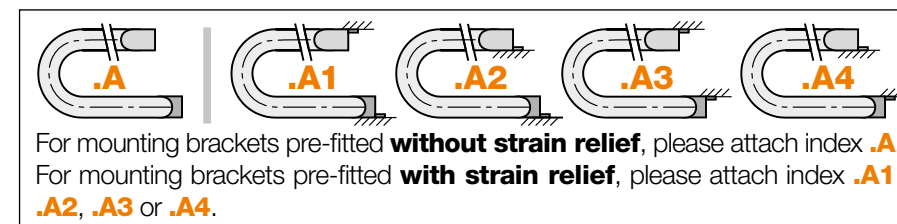

15000.038.34PZ.A1 Order example
 .A... to indicate option with brackets pre-fitted
 With integrated strain relief tiewrap plates
 Full set
 Width index
 Series



Option: steel mounting bracket, locking. For e-chains® and e-tubes, Part No. 14000.12
 ● Locking connections ● One part (2-piece) for all e-chain® widths ● Electrically conductive

Strain relief e.g. clamps, tiewrap plates, nuggets and clips are available from stock. The complete chainfix range with ordering options ▶ From page 1392

Strain relief e.g. clamps, tiewrap plates, nuggets and clips are available from stock. The complete chainfix range with ordering options ▶ From page 1392

Interior separation | Increase cable service life

Previous generation of interior separation with other options ► www.igus.eu/1400 ► www.igus.eu/1500

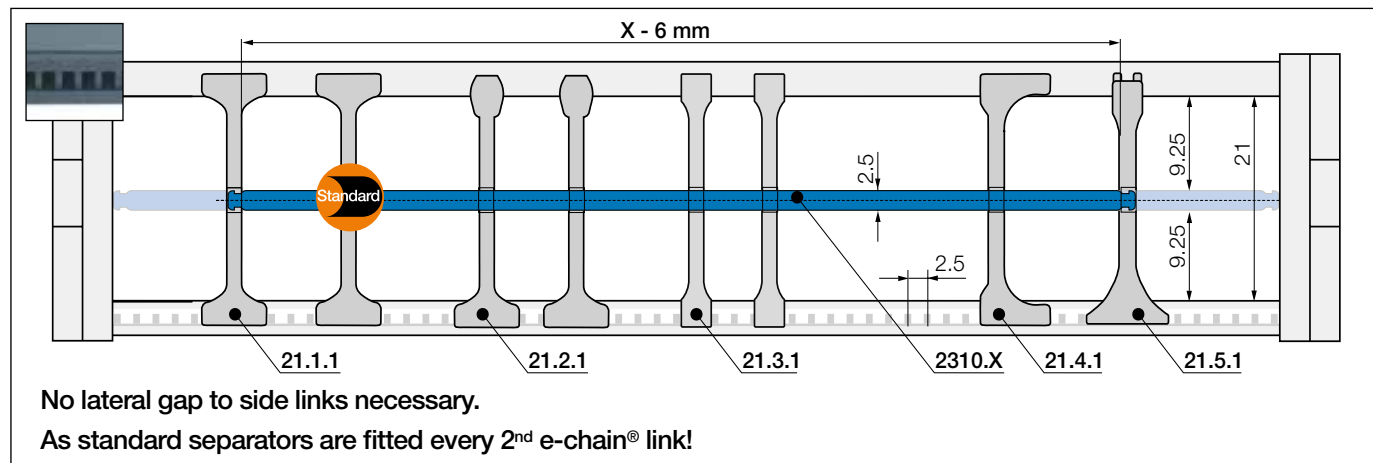

Standard separator, wide base

		unassembled	21.1
		assembled	21.1.1

Standard - for any application
Separator with a wide base for maximum holding force.

Separator, narrow top

		unassembled	21.2
		assembled	21.2.1

For even faster installation
Wide on one side for high holding force, narrow on opposite side for easy cable fitting.

Separator, narrow

		unassembled	21.3
		assembled	21.3.1

For small cables
Separator with a narrow base for a large number of small cables side by side. Saves space.

Separator, asymmetrical

		unassembled	21.4
		assembled	21.4.1

For side-mounted applications
Asymmetrical separator, for defined gap distance. No additional spacers required.

Notch separator for notched crossbar

		unassembled	21.5
		assembled	21.5.1

Locks securely in preset increments
Notch separator for exact positioning. Recommended for side-mounted applications.
Note: For this series notches only on fixed crossbars, not on openable crossbars

Shelf, lockable

		unassembled	2300.X
		assembled	2310.X

Horizontal separation
Full-width shelf locks securely into separators at both ends, giving a fixed width. Can be used as full-width or partial shelf.

Shelves Width = X [mm]	X [mm]		X [mm]		X [mm]	
	unassembled	assembled	unassembled	assembled	unassembled	assembled
	015	2300.015	2310.015	060	2300.060	2310.060
	025	2300.025	2310.025	062	2300.062	2310.062
	030	2300.030	2310.030	065	2300.065	2310.065
	038	2300.038	2310.038	070	2300.070	2310.070
	040	2300.040	2310.040	075	2300.075	2310.075
	050	2300.050	2310.050	077	2300.077	2310.077
	057	2300.057	2310.057	080	2300.080	2310.080
				087	2300.087	2310.087
				090	2300.090	2310.090
				100	2300.100	2310.100
				103	2300.103	2310.103
				110	2300.110	2310.110
				120	2300.120	2310.120
				125	2300.125	2310.125

Separator with integrated strain relief teeth

- Can be integrated into the mounting bracket or placed at any point
 - Combines strain relief and interior separation, for restricted space conditions
 - Strain relief separator is easy to assemble without any screws
- Part No. 21.1.Z - more information ► From page 1424



Aluminium support tray

- Corrosion-resistant and seawater-resistant aluminium rails with adjustable width
 - Noise-reducing glide strip integrated as standard
 - Easy installation and connection of the e-chain®
 - Open design - dirt and debris fall through
- More information ► From page 1362



E2/000 series 1400 in aircraft refuelling truck - telescopic crane with six sections