

BBS/FKK

BALL VALVE WITH FLANGES, SHORT PATTERN

DN 250-400 | PN 10-40

REDUCED BORE



MATERIALS

MATERIALS	PN	DN	Type 1	Type 2
Body	10-16	250	Grey cast iron	Grey cast iron
		300-400	Steel	Steel
	25-40	250-400	Steel	Steel
		Ball	10-25	250
300-400	Ductile iron, hard chromed			Ductile iron, hard chromed
40	250		Ductile iron, hard chromed	Ductile iron, hard chromed
Sealings	10-40	250-400	NBR	PTFE

INFORMATION

Ball Valve with flanges

/// Length face-to-face DIN EN 558 FTF 27/28

/// Flange dimensions DIN 2501 Blatt 1

/// TÜV-type approval

/// Scope of delivery without switch handle; on request with worm gear, pneumatic or electrical or electric drive available.

OPTIONS

/// Other shapes of flange sealing surfaces on request

/// Special designs on request

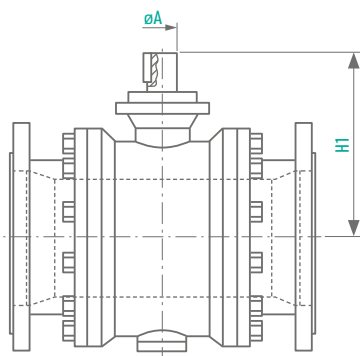
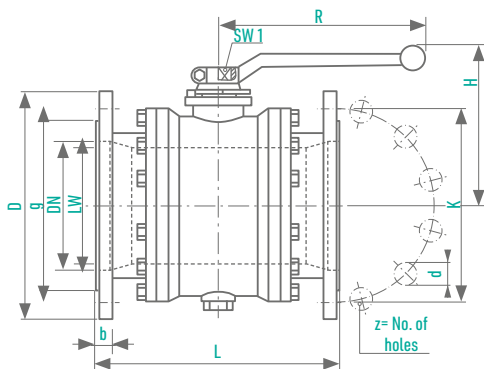

	DN	LW	PN	L	D	g	K	b	z	d	H	H1	R	SW1	aA	Wght	Order-Number	
																	Type 1	Type 2
PN 10 Raised face	250	200	10	450	395	320	350	26	12	22	275	-	600	32	-	124	0151123	0151179
	300	250	10	750	445	370	400	26	12	22	-	385	-	-	60	250	0156926	0156946
	350	300	10	850	505	430	460	26	16	22	-	427	-	-	60	450	0151128	0156948
	400	300	10	950	565	482	515	26	16	26	-	427	-	-	60	490	0151129	0156949
PN 16 Raised face	250	200	16	450	405	320	355	28	12	26	275	-	600	32	-	127	0151133	0151189
	300	250	16	750	460	378	410	28	12	26	-	385	-	-	60	260	0156931	0156951
	350	300	16	850	520	438	470	30	16	26	-	427	-	-	60	460	0156933	0156953
	400	300	16	950	580	490	525	32	16	30	-	427	-	-	60	500	0156934	0156954
PN 25 Raised face	250	200	25	450	425	335	370	32	12	30	275	-	600	32	-	134	0151143	0151199
	300	250	25	750	485	395	430	34	16	30	-	385	-	-	60	275	0156936	0156956
	350	300	25	850	555	450	490	38	16	33	-	427	-	-	60	480	0156938	0156958
	400	300	25	950	620	505	550	40	16	36	-	427	-	-	60	550	0156939	0156959
PN 40 Raised face	250	200	40	450	450	345	385	38	12	33	275	-	600	32	-	139	0151153	0151209