

Low weight, simply press cables in



Version E | Series E06 | "easy" design, split crossbar along the outer radius
Version Z | Series Z06 | "easy" design, split crossbar along the inner radius

Part No. Version E	Part No. Version Z	Bi [mm]	Ba* [mm]	R Available bend radii [mm]	Weight [kg/m]
E06.10.R.0 ¹⁾	Z06.10.R.0 ¹⁾	10	16.5	018 028 038	≈ 0.14
E06.16.R.0 ¹⁾	Z06.16.R.0 ¹⁾	16	22.5	018 028 038	≈ 0.16
E06.20.R.0	Z06.20.R.0	20	26.5	018 028 038	≈ 0.18

1) Crossbars do not overlap. Gap = 5.5mm Special solution with opening gap 3.5mm: Part No. E06.10.018.0.S3

Ba*: pin dimension approx. 1.5 - 2.0mm wider.

Complete Part No. with required radius (R). Example: E06.10.028.0

Installation dimensions

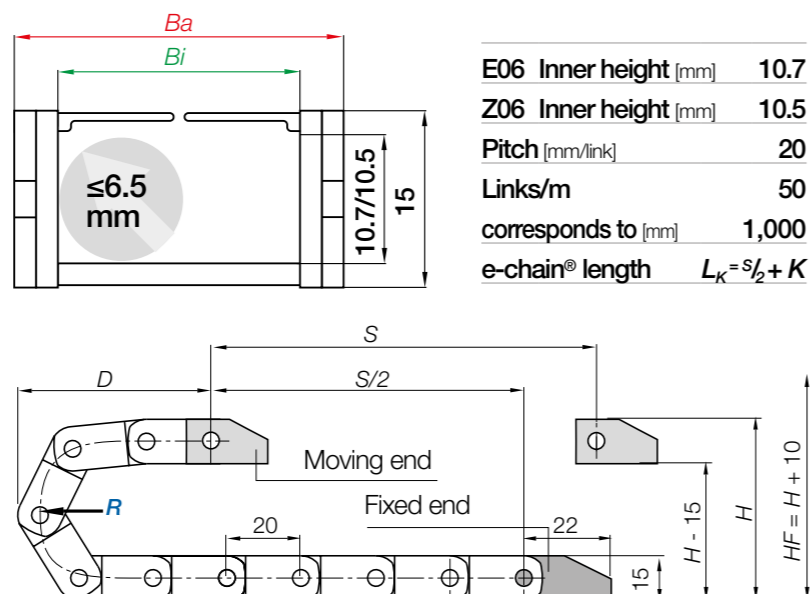
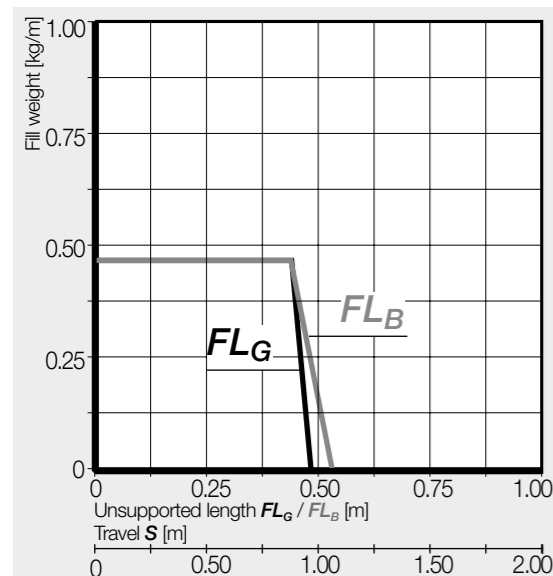

R	018	028	038
H	51	71	91
D	56	66	76
K	100	130	160

The required clearance height: $H_F = H + 10\text{mm}$ (with 0.2kg/m fill weight)

Mounting brackets, polymer one-piece | Locking

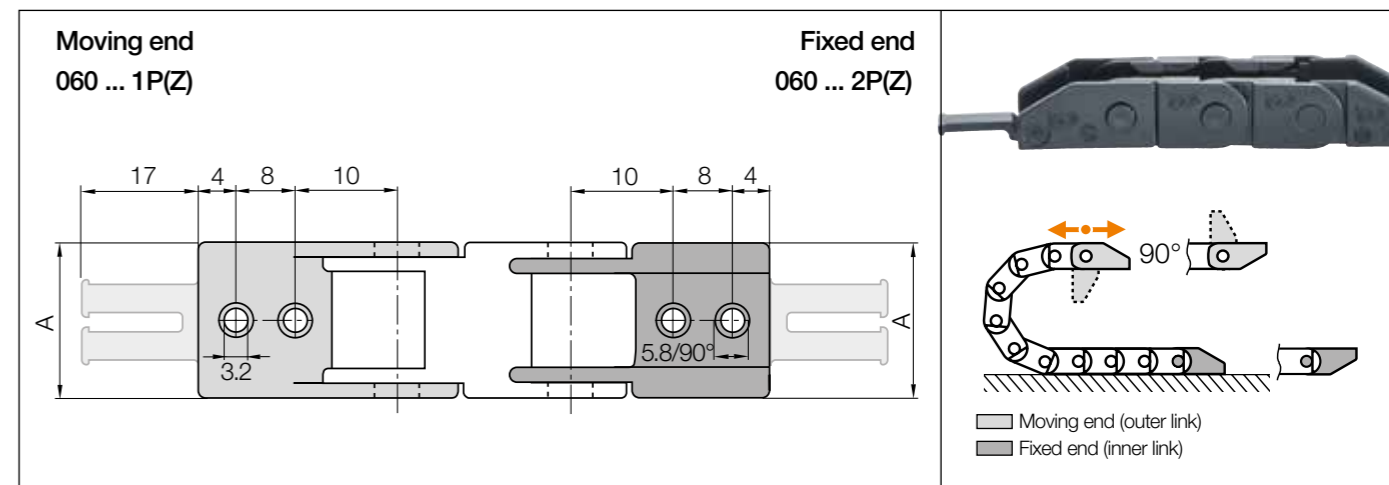

Width index	Part No. full set with tiewrap plates	Part No. full set without tiewrap plates	A [mm]	Number of teeth
10. ►	060.10.12PZ	060.10.12	16.5	1
16. ►	060.16.12PZ	060.16.12	22.5	2
20. ►	060.20.12PZ	060.20.12	27.0	2

Material mounting bracket - igumid G, temperature: -40° up to +120°C, VDE 0304 IIC UL94-HB

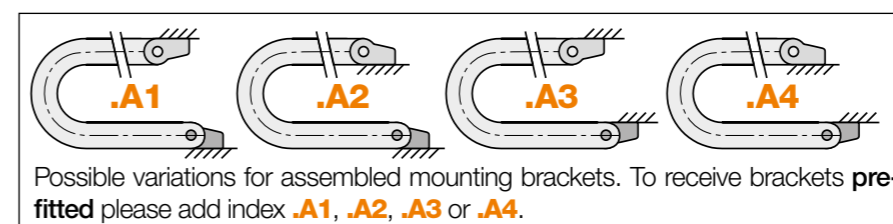

Possible variations for assembled mounting brackets. To receive brackets pre-fitted please add index .A1, .A2, .A3 or .A4.

060.10.12PZ.A1 Order example
.A... to indicate option with brackets pre-fitted
With integrated strain relief tiewrap plates
Full set
Series