

Submersible motor pumps
with jacket cooling
for chemically aggressive media.

Chromatic CH250, CH260

Application

Pump for conveying chemically aggressive waste water such as salt water (up to 15%) from softening plants, condensate from condensing boilers, waste water from car washes, swimming pool water, sea water, brackish water, silage juice and liquid fertilizer. Drying of pits, shafts, rooms. Waste water disposal in industry and trade. Reduction of surface water. Emergency deployment for flooding. A cooling jacket with discharge connector at the top ensures sufficient motor cooling even at low water level (sip operation). Automatic ventilation with additional air vent screw. Removable strainer allows extraction of residual water down to 5 mm. Automatic purging device can be implemented.

DIN EN 12050-2: Design tested and monitored.

Installation: Stationary or mobile. Version with float switch for use as automatic water level controlled drainage pump.

Pumped medium: Chemically aggressive drainage water with solid content up to 10 mm grain size. Max. temperature of pumped medium: 35°C, for brief periods up to 60°C.

Operating mode: Continuous operation (S1), at medium temperature 36- 60°C. Intermittent operation (S3 30%).

Design

Submersible pump, consisting of:

Pump: Single stage centrifugal pump with vertical discharge and integrated non-return valve.

Impeller: Open multi-blade impeller, free passage 10 mm.

Motor: Pressure watertight, medium-immersed motor. Stainless steel motor housing. Insulation class B, Protection rating IPX8. With thermal sensor in the winding for temperature monitoring.

Connecting cable: H07RN8-F 3G1.

Shaft/bearing: strongly dimensioned chrome steel motor shaft, lifetime-lubricated roller bearings

Seal: Shaft seal with a combination of dual shaft sealing ring and a mechanical seal.

Conveying capacities

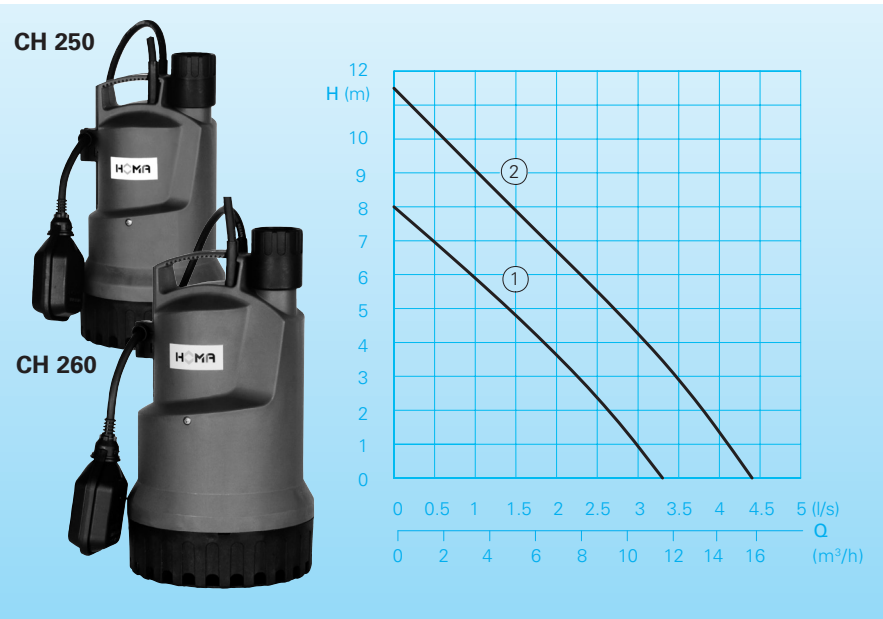

Technical data

Curve No.	Pump type	Motor input P ₁ (kW) P ₂ (kW)		Voltage 50 Hz (V)	Nominal current (A)	Weight (kg)
①	CH250 W(A)	0,55	0,26	230/1Ph	2,5	5,3
②	CH260 W(A)	0,90	0,48	230/1Ph	4,0	6,1

Rotational speed: 2850 rpm
Discharge: G1 1/4

Model A: with automatic float switch
HOMA-Nivomatik

Materials

Motor housing, motor shaft, screws	highly-resistant stainless steel
Suction sieve, outer housing, impeller, pressurized lid	impact-resistant plastic
Mechanical seal	SiC/SiC
Elastomers	NBR

Scope of supply

Pump with twin box G 1¼ inc. integrated non-return valve, washer and hose connection, 10 m connecting cable and mains plug.

Model A: With automatic HOMA-Nivomatik float switch.

Dimensions and installation example (all dimensions in mm)

CH250

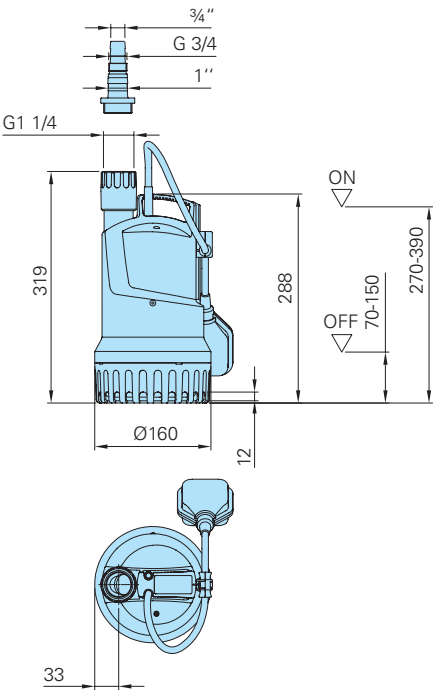

CH260

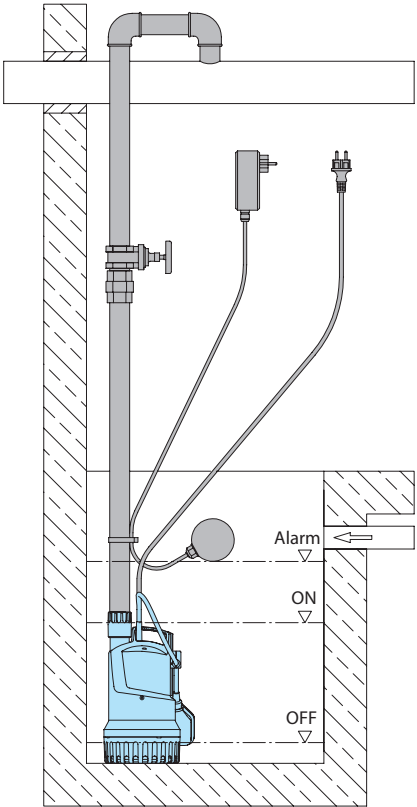
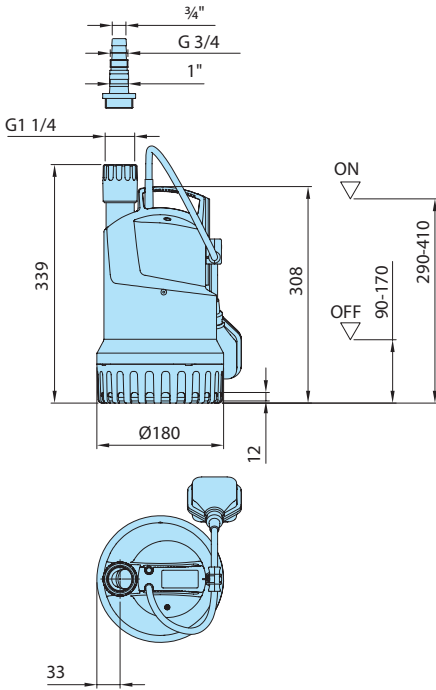

Accessories

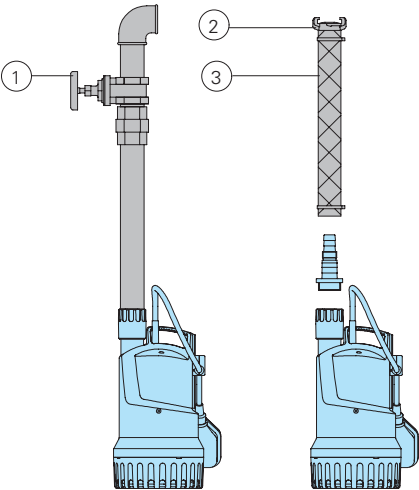

Description	Size	Part no.
① Shut-off gate valve, Brass	BSP 1 1/4" F	2216012
○ Non-return valve, brass (if the integrated non-return valve is omitted)	BSP 1 1/4" F	2211213
○ Double nipple, galvanized	BSP 1 1/4" M	2009011
② Fixed coupling, brass	BSP 1 1/4" M	2005413
Hose coupling, brass	1 1/4"	2003413
	1"	2003313
	3/4"	2003212
③ PVC-hose, per m	1 1/4" Ø 30mm	2621200
	1" Ø 25 mm	2621000
	3/4" Ø 19 mm	2620700
Plastic spiral hose, per m	1 1/4" Ø 32mm	2632030
	1" Ø 25 mm	2632025
	3/4" Ø 19 mm	2632019
Hose clamp	1 1/4"	2302330
	3/4"-1"	2303252
○ Check valve, Shut-off gate valve, fittings made of resistant plastic or stainless steel		on request

Description	Size	Part no.
○ Fault-current circuit breaker 2-pin, Fi 16/0.03 A		1561160
○ Mains-dependent alarm control unit AL3 with connector for 9 V rechargeable battery (see below) for operation independent of mains power supply, with built-in signal transmitter, float switch and 10 m of cable. Main phase connection 230V/1Ph		1586141
9 V rechargeable battery for mains-independent alarm		1952215
○ Pump controllers and switchgears for mobile and stationary applications, measuring systems and monitoring devices, see HOMA accessories		



We reserve the right to alter our specifications without notice!

HOMA Pumpenfabrik GmbH | Industriestraße 1, D-53819 Neunk.-Seelscheid | Tel. +49 (0) 22 47 / 702-0, Fax +49 (0) 22 47 / 702-44 | info@homa-pumpen.de | www.homapumps.com



HENNlich -
ŽIJEME TECHNIKOU

o.z. HYDRO-TECH HENNlich s.r.o.
Českolipská 9, 412 01 Litoměřice

Telefon: +420 416 711 222
E-mail: hydro-tech@hennlich.cz

www.hennlich.cz/hydro-tech