



HENNLICH

MERES

## C-150-E

### Cold applied low profile power connection

#### PRODUCT OVERVIEW

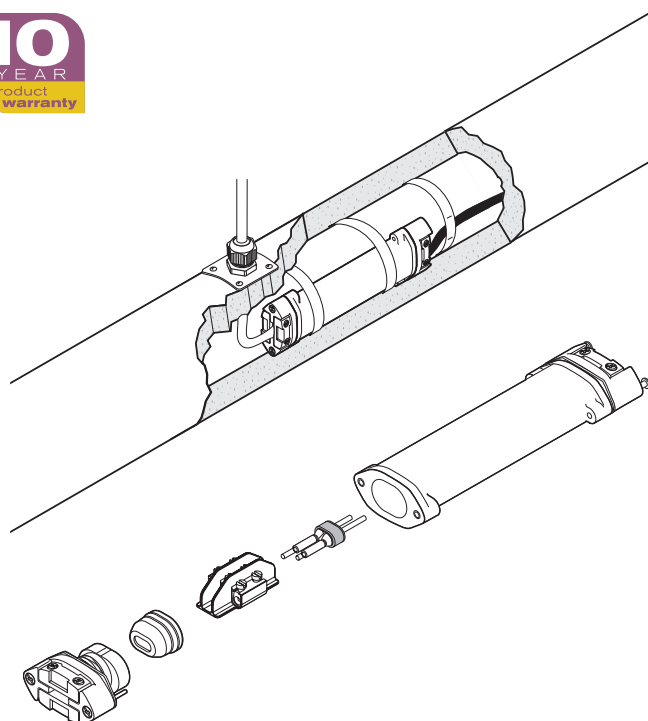

The nVent RAYCHEM C-150-E is a cold applied low profile power connection. The kit enables in line connection of nVent RAYCHEM industrial heating cables, BTV, QTVR and XTVR, to a flexible power cable. It can be used in applications with temperature ratings from  $-55^{\circ}\text{C}$  to  $200^{\circ}\text{C}$ . It is approved for use in hazardous areas.

A nVent RAYCHEM supplied power cable such as C-150-PC may be used or any suitable standard industrial power cable type  $3 \times 1.5 \text{ mm}^2$  or  $3 \times 2.5 \text{ mm}^2$  with stranded copper conductors and an outer insulation jacket. The power cable is connected by means of screw terminals to the conductors and the braid of the heating cable.

C-150-E is used as connector:

- where connection to a junction box is difficult e.g. because of space limitation
- on instrument lines or loading arms
- where installation of "under insulation" components is preferred
- as a cost effective solution for short heat-tracing lines as an alternative for JBS-100.

#### Application

Cold applied low profile splice for connection of BTV, QTVR and XTVR heating cables to a power cable

#### Kit contents

- 1 splice housing assembly including
  - 1 sealing grommet assembly for heater
  - 1 pressure plate/strain relief assembly
- 1 core sealer for heater
- 1 spacer including screw terminal
- 1 sealing grommet assembly for the power cable
- 1 pressure plate/strain relief assembly for the power cable
- 1 identification label
- 1 installation instruction



## ORDERING INFORMATION

Part description	C-150-E
PN (Weight)	073704-000 (0.4 kg/0.8 lb)
Pack size	1 bag

## Accessories

Power cable	C-150-PC 3-core flexible power cable for connection to C-150-E, 3 x 2.5 mm <sup>2</sup> , silicone insulation, temperature range: -40°C to +180°C, short term: 215°C
-------------	---

