



HENNLICH

MERES

## C25-100-METAL and C3/4-100-METAL

### Cold applied metal connection kit

#### PRODUCT OVERVIEW

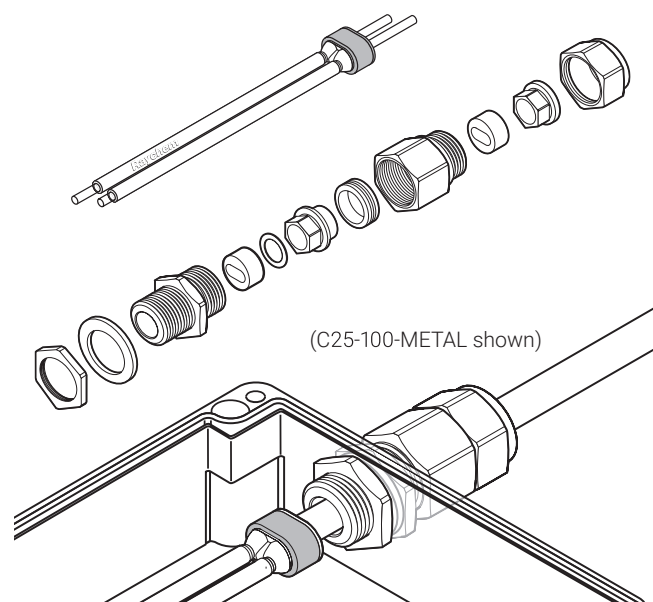

These connection kits are designed for terminating all nVent RAYCHEM BTV, QTVR, XTV, KTV, HTV and VPL industrial parallel heating cables to a junction box, whilst maintaining electrical insulation of the heating cable conductors and core.

The braid is directly connected to the metal gland body. The connection kits can be used with metal boxes or plastic boxes with internal earthing plate. They are approved for use in hazardous areas.

The core sealing boot does not require a heat gun or torch for the installation (no hot work permit necessary). The non-curing sealant allows easy installation and facilitates maintenance purposes.

The C25-100-METAL kit is designed for use with M25 entries, the C3/4-100-METAL for 3/4" NPT entries.

A metal locknut is included.

#### Application

Connection kit for BTV, QTVR, XTV, KTV, HTV and VPL parallel heating cables

#### Kit contents

- 1 gland,
- 2 grommets,
- 1 locknut and sealing washer (only M25),
- 1 core sealer,
- 1 installation instruction (multilingual).

## PRODUCT SPECIFICATION

### Technical Details

|                           | C25-100-METAL | C3/4-100-METAL |
|---------------------------|---------------|----------------|
| Thread size               | M25 x 1.5     | 3/4" NPT       |
| Gland material            | Brass         | Brass          |
| Min. ambient temperature  | -60°C         | -60°C          |
| Max. exposure temperature | 180°C         | 180°C          |

### APPROVALS

For use in ordinary and hazardous area Zone 1 and Zone 2 (Gas), Zone 21 and Zone 22 (Dust)

#### Temperature classification

Temperature classification is defined by the complete system.

#### Product certification



More details about product certification, approvals and conditions of safe use are available in the installation manual at [www.nVent.com/RAYCHEM](http://www.nVent.com/RAYCHEM).

### ORDERING INFORMATION

|                  |                       |                      |
|------------------|-----------------------|----------------------|
| Part description | C25-100-METAL         | C3/4-100-METAL       |
| PN (Weight)      | 875016-000 (0.31 kg)  | 440588-000 (0.3 kg)  |
| Gland material   | Brass                 | Brass                |
| Part description | C25-100-METAL-NP      | C3/4-100-METAL-NP    |
| PN (Weight)      | 1244-002296 (0.31 kg) | 1244-001350 (0.3 kg) |
| Gland material   | Nickel Plated Brass   | Nickel Plated Brass  |
| Part description | C25-100-METAL-SS      |                      |
| PN (Weight)      | 1244-017869 (0.3 kg)  |                      |
| Gland material   | Stainless Steel       |                      |