

## Model RU (Integrated Inner/Outer Ring Type)

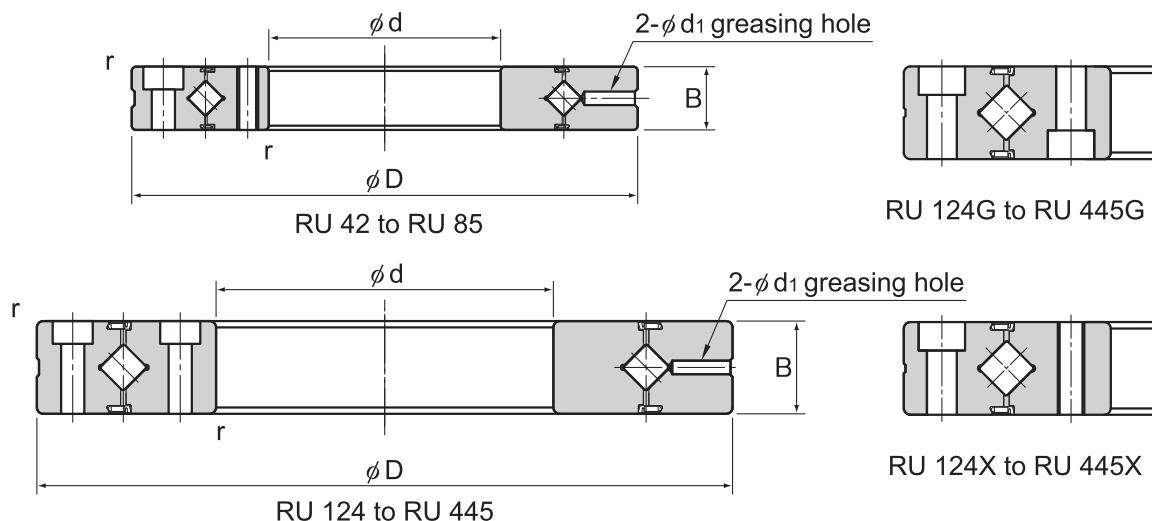

Shaft diameter	Model No.	Main dimensions						Shoulder height		Basic load rating (radial)		Mass
		Inner diameter d	Outer diameter D	Roller pitch circle diameter dp	Width B	Greasing hole d <sub>1</sub>	r <sub>min</sub>	ds (max)	Dh (min)	C kN	C <sub>0</sub> kN	
20	RU 42	20	70	41.5	12	3.1	0.6	36	47	7.35	8.35	0.29
35	RU 66	35	95	66	15	3.1	0.6	59	74	17.5	22.3	0.62
55	RU 85	55	120	85	15	3.1	0.6	77	93	20.3	29.5	1
80	RU 124 (G) RU 124X	80	165	124	22	3.1	1	114	134	33.1	50.9	2.6
90	RU 148 (G) RU 148X	90	210	147.5	25	3.1	1.5	133	162	49.1	76.8	4.9
115	RU 178 (G) RU 178X	115	240	178	28	3.1	1.5	161	195	80.3	135	6.8
160	RU 228 (G) RU 228X	160	295	227.5	35	6	2	208	246	104	173	11.4
210	RU 297 (G) RU 297X	210	380	297.3	40	6	2.5	272	320	156	281	21.3
350	RU 445 (G) RU 445X	350	540	445.4	45	6	2.5	417	473	222	473	35.4

Note) Optional grease nipple available for model RU. (See figure below.)  
To indicate that you want grease nipples, add "-N" to the end of the model number.

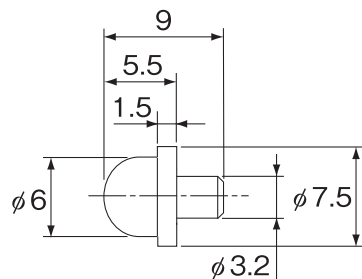

NP3.2×3.5

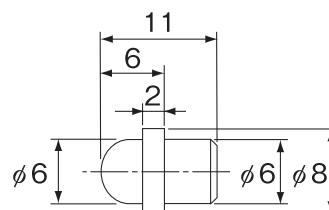

NP6×5

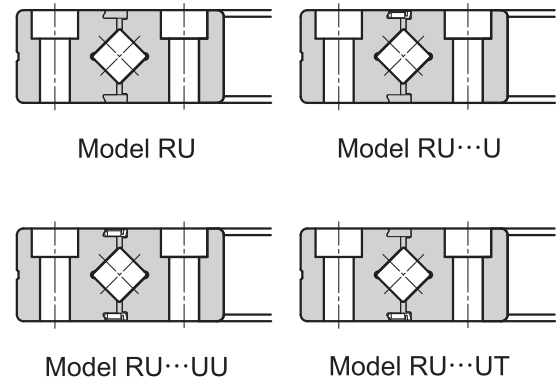
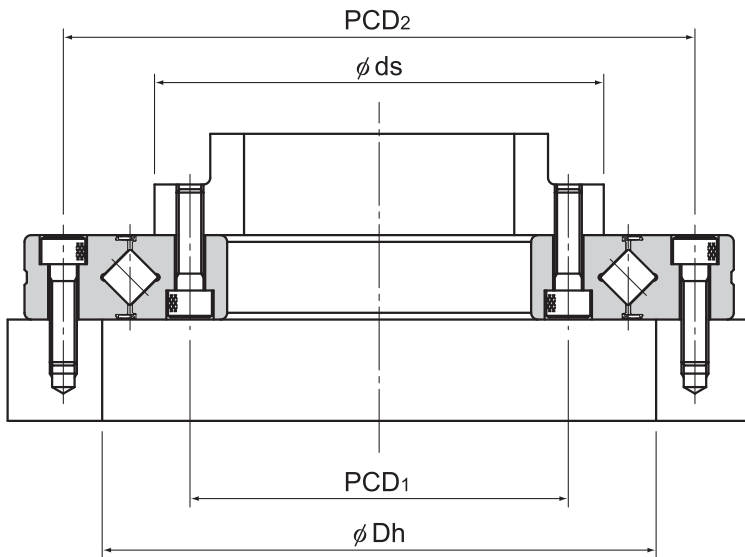

Unit: mm

Mounting Hole Related				
Inner ring			Outer ring	
PCD <sub>1</sub>	Mounting hole	PCD <sub>2</sub>	Mounting hole	
28	6-M3 through	57	6-φ3.4 drilled through, φ6.5 counter bore depth 3.3	
45	8-M4 through	83	8-φ4.5 drilled through, φ8 counter bore depth 4.4	
65	8-M5 through	105	8-φ5.5 drilled through, φ9.5 counter bore depth 5.4	
97	10-φ5.5 drilled through, φ9.5 counter bore depth 5.4 10-M5 through	148	10-φ5.5 drilled through, φ9.5 counter bore depth 5.4	
112	12-φ9 drilled through, φ14 counter bore depth 8.6 12-M8 through	187	12-φ9 drilled through, φ14 counter bore depth 8.6	
139	12-φ9 drilled through, φ14 counter bore depth 8.6 12-M8 through	217	12-φ9 drilled through, φ14 counter bore depth 8.6	
184	12-φ11 drilled through, φ17.5 counter bore depth 10.8 12-M10 through	270	12-φ11 drilled through, φ17.5 counter bore depth 10.8	
240	16-φ14 drilled through, φ20 counter bore depth 13 16-M12 through	350	16-φ14 drilled through, φ20 counter bore depth 13	
385	24-φ14 drilled through, φ20 counter bore depth 13 24-M12 through	505	24-φ14 drilled through, φ20 counter bore depth 13	

Cross-Roller Ring

### Model number coding

**RU124 UU CC0 P2 B G -N**

Model No.

Accuracy symbol (\*2)

Radial clearance symbol (\*1)

Sub-part Accuracy symbol

No Symbol : Rotational Accuracy of the Inner Ring  
R : Rotational Accuracy of the Outer Ring  
B : Rotational Accuracy of the Inner/Outer Rings

Grease nipple symbol

No Symbol : No grease nipples included

-N : Grease nipples attached (2)

(For the nipple's shape, see the figure on the left.)

RU42 to RU178: NP3.2×3.5

RU228 to RU445: NP6×5

Seal symbol

No Symbol : Without seal

UU : Seal attached on both ends

U : Seal attached on either end (counterbore side of the outer ring)

UT : Seal attached on either end (opposite to the counterbore side of the outer ring)

Mounting Hole Symbol

[Applicable Models : RU124 to RU445(RU42 to RU85 do not apply)]

No Symbol : The counterbore holes of the inner and outer rings face the same direction

G : The counterbore holes of the inner and outer rings face opposite direction

X : Inner ring tapped hole (through hole)

(\*1) See **A18-18**. (\*2) See **A18-12**.

**THK A18-23**