

## Cold applied low profile power connection

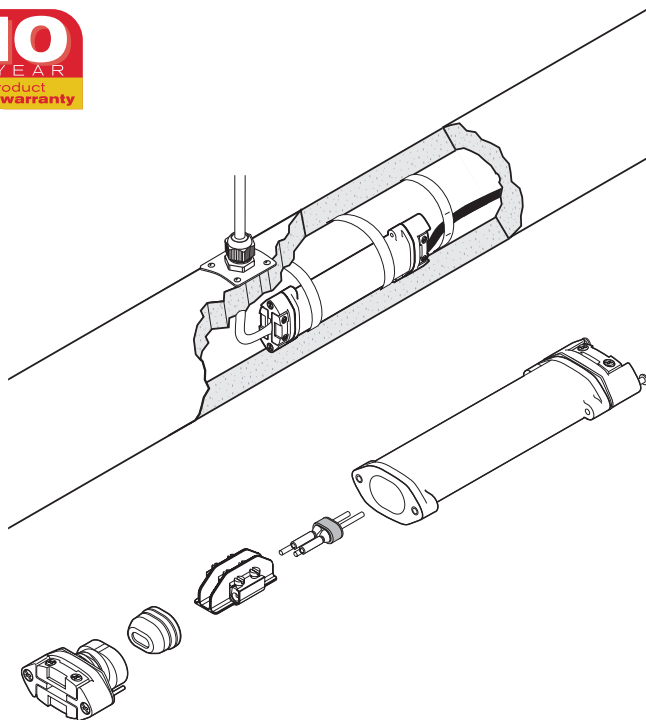

The nVent RAYCHEM C-150-E is a cold applied low profile power connection. The kit enables in line connection of nVent RAYCHEM industrial heating cables, BTV, QTVR, XTV and KTV, to a flexible power cable. It can be used in applications with temperature ratings from  $-55^{\circ}\text{C}$  to  $200^{\circ}\text{C}$ . It is approved for use in hazardous areas.

A nVent RAYCHEM supplied power cable such as C-150-PC may be used or any suitable standard industrial power cable type  $3 \times 1.5 \text{ mm}^2$  or  $3 \times 2.5 \text{ mm}^2$  with stranded copper conductors and an outer insulation jacket. The power cable is connected by means of screw terminals to the conductors and the braid of the heating cable.

C-150-E is used as connector:

- where connection to a junction box is difficult e.g. because of space limitation
- on instrument lines or loading arms
- where installation of "under insulation" components is preferred
- as a cost effective solution for short heat-tracing lines as an alternative for JBS-100.

### DESCRIPTION

Cold applied low profile splice for connection of BTV, QTVR, XTV and KTV heating cables to a power cable

### KIT CONTENTS

- 1 splice housing assembly including
  - 1 sealing grommet assembly for heater
  - 1 pressure plate/strain relief assembly
- 1 core sealer for heater
- 1 spacer including screw terminal
- 1 sealing grommet assembly for the power cable
- 1 pressure plate/strain relief assembly for the power cable
- 1 identification label
- 1 installation instruction

## APPROVALS

DEKRA 20ATEX0011U

Ex II 2 G Ex eb IIC Gb

Ex II 2 D Ex tb IIIC Db

IECEx DEK 20.0005U

**Ex** TC RU C-BE.MЮ62.B.00054/18  
000 «TexИмпорт»  
Ta : -55°C...+150°C Power ON IP66  
Ta : -55°C...+200°C Power OFF  
Ex e IIC Gb U  
Ex tb IIIC Db U

**CCC** Ex e IIC Gb  
Ex tD A21 IP66

DNV approval

When used with BTV, QTVR Heating system: DNV Certificate number TAE00000TU

When used with XTV, KTV Heating systems: DNV Certificate number TAE00000TV

**SP** Ex eb IIC T\* Gb  
Ex tb IIIC T\* °C Db+

## DIMENSIONS (IN MM)

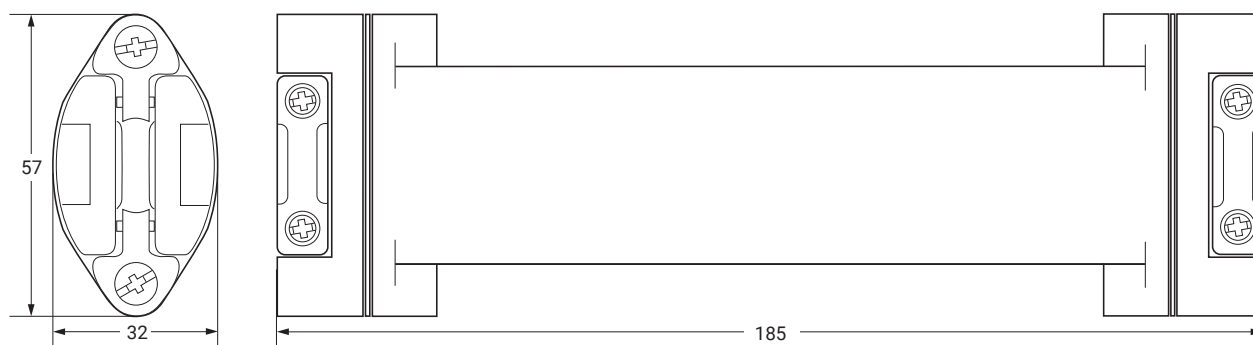

## PRODUCT SPECIFICATIONS

Heating cable capability	BTV-CR, BTV-CT, QTVR-CT, XTV-CT, KTV-CT						
Power cable capability	For use with nVent RAYCHEM's high temperature power cable C-150-PC or for use with other flexible cable such as: H07RN-F, Silicone insulated cables. Minimum and maximum installation and operating temperatures, given by cable manufacturer, have to be considered by designer and installer.						
Power cable dimension	-> outer diameter range 7.8 mm - 12.5 mm -> 3 stranded copper conductors (3 x 2.5 mm <sup>2</sup> or 3 x 1.5 mm <sup>2</sup> ) -> temperature range depending on the application						
Maximum power cable length	Depending on power cable voltage drop and maximum current for nVent RAYCHEM power cable C-150-PC (3 x 2.5 mm <sup>2</sup> ): <table><tr><td>CB 16 A</td><td>40 m</td></tr><tr><td>CB 20 A</td><td>32 m</td></tr><tr><td>CB 25 A</td><td>25 m</td></tr></table>	CB 16 A	40 m	CB 20 A	32 m	CB 25 A	25 m
CB 16 A	40 m						
CB 20 A	32 m						
CB 25 A	25 m						
Ingress protection	IP66						
Minimum installation temperature	-55°C						
Maximum pipe temperature	refer to heating cable specification						
Maximum operating voltage	277 Vac						
Maximum current rating	depending on the power cable used and maximum current						

## CONSTRUCTION MATERIALS

Housing, end plate, shim and spacer	Engineering polymers, black
Sealing grommets	Silicone rubber
Screws, compression spring	Stainless steel

## ORDERING DETAILS

Part description	C-150-E
PN (Weight)	073704-000 (0.4 kg/0.8 lb)
Pack size	1 bag

## ACCESSORIES

---

Power cable

C-150-PC

3-core flexible power cable for connection to C-150-E,  
3 x 2.5 mm<sup>2</sup>, silicone insulation, temperature range: -40°C to +180°C,  
short term: 215°C

---