

DF-RW

External magnetic-fields immune electronic sensor

Sensors assembled on the cylinders detect the position of the piston by switching an electric signal as the magnetic-field produced, by the magnet in the piston, approaches.
Typically used in applications where strong magnetic fields may influence the sensor conditions.
Particularly suitable in the Automotive applications and in the nearby of welding-machines.
2 colors (red and green) LED indicator for an optimal position detection.

TECNICAL CHARACTERISTICS

| Type | ELECTRONIC | |
|--------------------------------|------------------------------------|-------------|
| Part no. | DF-RW700L03 | DF-RW700M12 |
| Working voltage (V DC) | 10÷28 V DC | 10÷28 V DC |
| Max switching current (mA) | 5÷50 | 5÷50 |
| Max switching power (W) | 1,5 | 1,5 |
| Temperature (°C) | -10 ÷ +60 | |
| Max voltage drop (V AC/DC) | 5 | 5 |
| Cable number and section (mmq) | 2x4,8 (PUC) | 2x4,8 (PUC) |
| Cable lenght (mm) | 3000 | 500 |
| Contact | NO | NO |
| Max response time (ms) | 50 | 50 |
| State indicator (LED) | red (detection position) | |
| | green (optimal detection position) | |
| Protection degree (IEC 60529) | IP67 | |
| Shock resistance (G) | 50 | 50 |

EXTENSION CABLES

| | |
|--|------------|
| 3m ext. cable with M12 3-poles connect. max 60 V | DHF-033M12 |
| 5m ext. cable with M12 3-poles connect. max 60 V | DHF-053M12 |

When using the M12 3-poles extensions cable with DF-RW, DF-RX magnetic sensors, exclude the blue wire before to connect.

Pay attention to correct polarity connection while using direct current; avoid magnetic fields to influence the electronic sensor; provide the KM-008200 filter in case of use of extension cables longer than 10m; provide dedicated filters in case of use of inductive loads.

Subject to change



Dimensions

DF-RW700L03

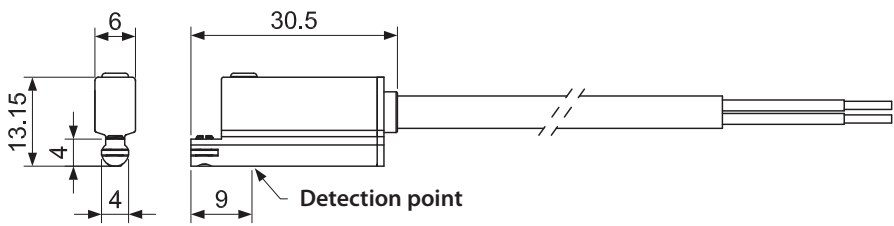

DF-RW700M12

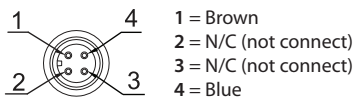
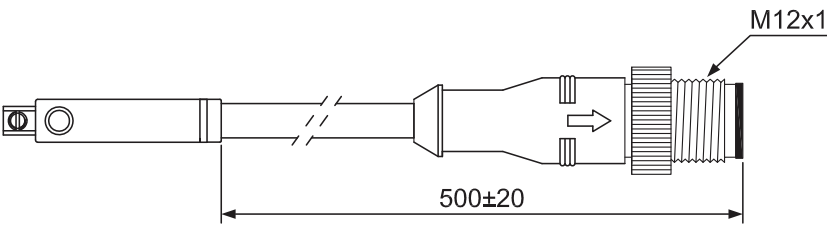

Sensor/Cylinder matching table

| | DF-RW | DF-RW + DF-R002 | DF-RW + DF-R003 |
|-----------------|----------------|-----------------|-----------------|
| Cylinder series | JX1 | M | JLES (Ø16÷63) |
| | JX2 | KE/KD/KL | JLEV (Ø16÷63) |
| | YMA20 | RP/RO | |
| | YMP20 | RM/RN | |
| | YMP30 | RS/RQ | |
| | YMP50 (Ø16÷25) | OV | |
| | JLES (Ø12) | R | |
| | JLEV (Ø12) | W | |
| | YR3 | JTES | |
| | | JTEV | |
| | | YMA11 | |
| | | YMP40 | |
| | | YMP50 (Ø32÷63) | |

DF-R002/DF-R003 adaptor
Adaptor for sensor assembly on T-type groove
(to be ordered separately)

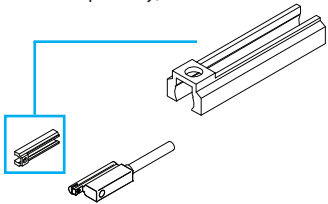

5

Electrical Circuit

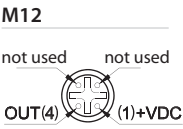
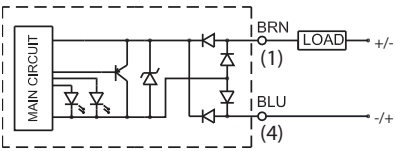

2 colors LED indicator

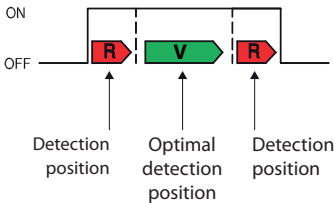

Detection position: red LED on.
Optimal detection position: green LED on.

Assembly scheme with adaptor

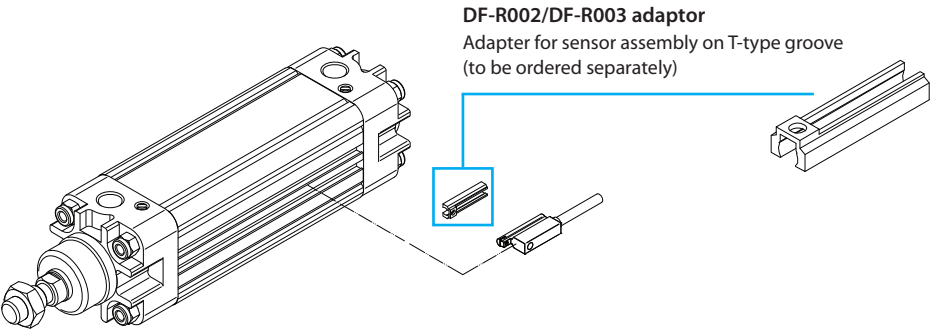

DF sensor cable clamping

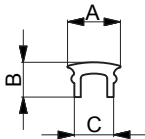
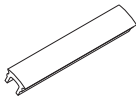
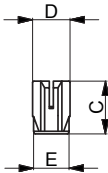
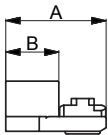
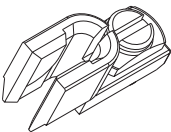

Material: body: polycarbonate
screw: chrome-plated steel

| A | B | C | D | E | Part no. |
|----|-----|-----|-----|-----|----------|
| 15 | 7,8 | 7,9 | 5,8 | 5,5 | DF-001 |

DF sensor covering strip

Material: pvc

| A | B | C | Part no. |
|---|-----|-----|------------|
| 7 | 4,6 | 5,2 | DHF-002010 |